

DOWNTOWN STATION AREA SPECIFIC PLAN PROGRAM EIR

State Clearinghouse Number: 2006072104

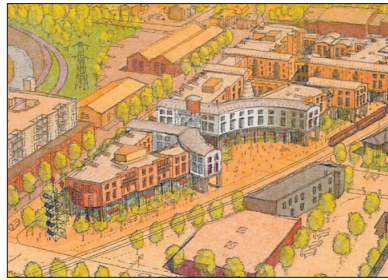
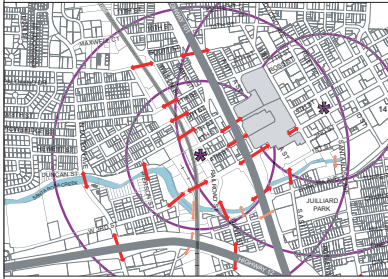

Submitted to
City of Santa Rosa | June 29, 2007

Prepared by:
City of Santa Rosa, Advanced Planning and Public Policy Department

Lead EIR Consultant:
DESIGN, COMMUNITY & ENVIRONMENT



Final Program EIR

DOWNTOWN STATION AREA SPECIFIC
PLAN PROGRAM EIR

State Clearinghouse Number: 2006072104

Submitted to

City of Santa Rosa | June 29, 2007

Prepared by:

City of Santa Rosa, Advanced Planning and Public Policy Department

Lead EIR Consultant:



DESIGN, COMMUNITY & ENVIRONMENT

**1625 SHATTUCK AVENUE, SUITE 300
BERKELEY, CALIFORNIA 94709**

**TEL: 510 848 3815
FAX: 510 848 4315**

in association with:

Coastland Civil Engineering
Garcia & Associatesay Group
Illingworth & Rodkin, Inc.

Questa Engineering Corporation
Whitlock & Weinberger Transportation

