

CITYWIDE SUMMARY OF PENDING DEVELOPMENTS

June 2011

All Quadrants

Residential (Units)	Pending	Approved
Single-Family Detached	280	1,846
Single-Family Attached	376	1,354
Live / Work	0	0
Multi-Family	327	691
Second Units	4	138
Senior Units	118	179
Total:	1,105	4,208

Non-Residential (Sq Ft)	Pending	Approved
Retail	91,722	208,667
Office	114,100	75,806
Light Industrial	0	61,338
Industrial	0	6,835
Public / Institutional	49,250	67,303
Total:	255,072	419,949

City of Santa Rosa Department of Community Development

SUMMARY OF PENDING DEVELOPMENTS IN NORTHEAST QUADRANT

June 2011

Northeast Quadrant

Residential (Units)	Pending	Approved
Single-Family Detached	30	115
Single-Family Attached	61	291
Live / Work	0	0
Multi-Family	18	112
Second Units	0	1
Senior Units	0	179
Total:	109	698

Non-Residential (Sq Ft)	Pending	Approved
Retail	59,947	20,677
Office	114,100	326,106
Light Industrial	0	0
Industrial	0	0
Public / Institutional	0	32,331
Total:	174,047	379,114

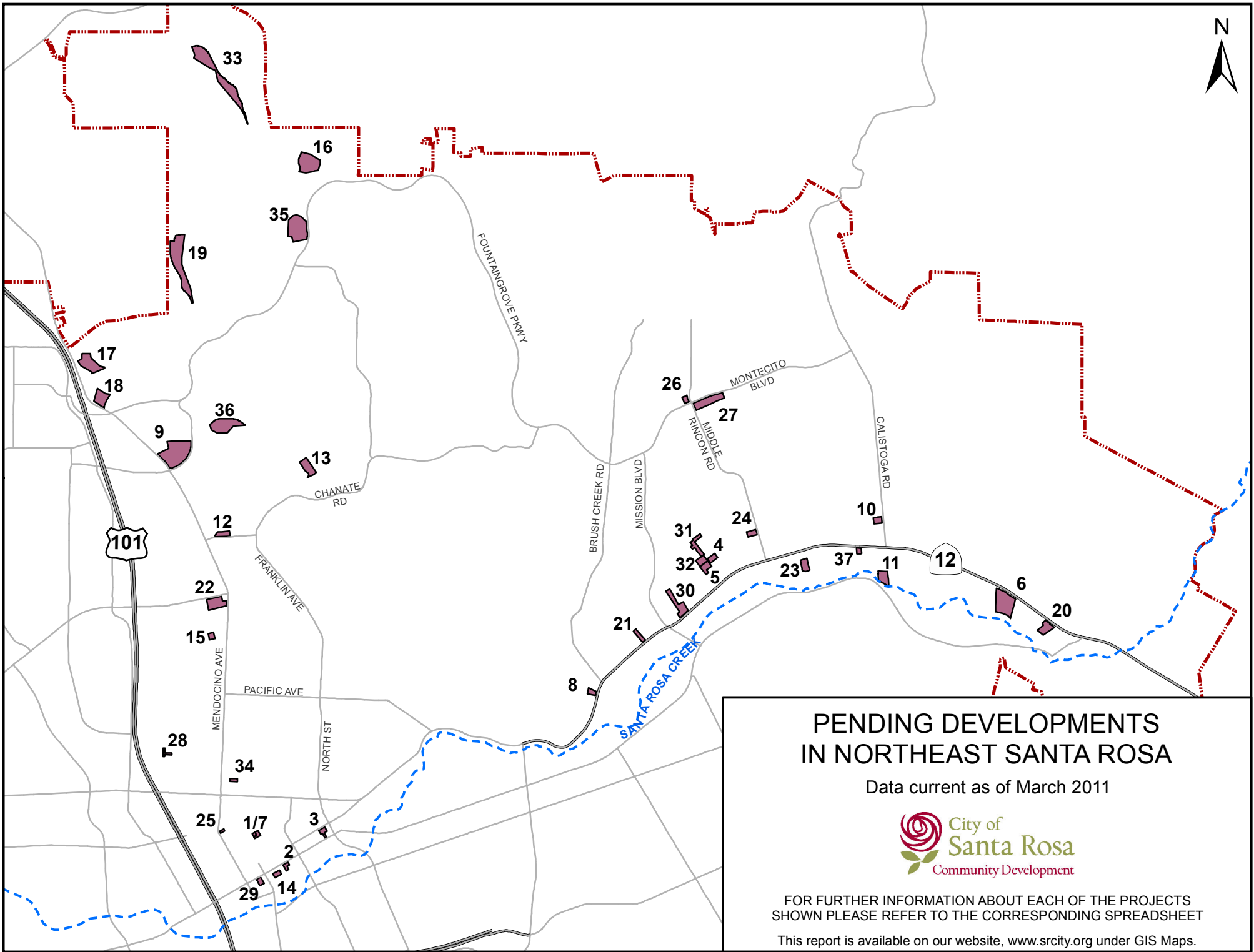

City of Santa Rosa Department of Community Development

SUMMARY OF PENDING DEVELOPMENTS IN NORTHWEST QUADRANT

June 2011

Northwest Quadrant

Residential (Units)	Pending	Approved
Single-Family Detached	167	577
Single-Family Attached	220	219
Live / Work	0	0
Multi-Family	18	82
Second Units	0	51
Senior Units	0	0
Total:	405	929

Non-Residential (Sq Ft)	Pending	Approved
Retail	16,900	22,330
Office	0	43,700
Light Industrial	0	25,558
Industrial	0	6,835
Public / Institutional	49,250	24,408
Total:	66,150	122,831

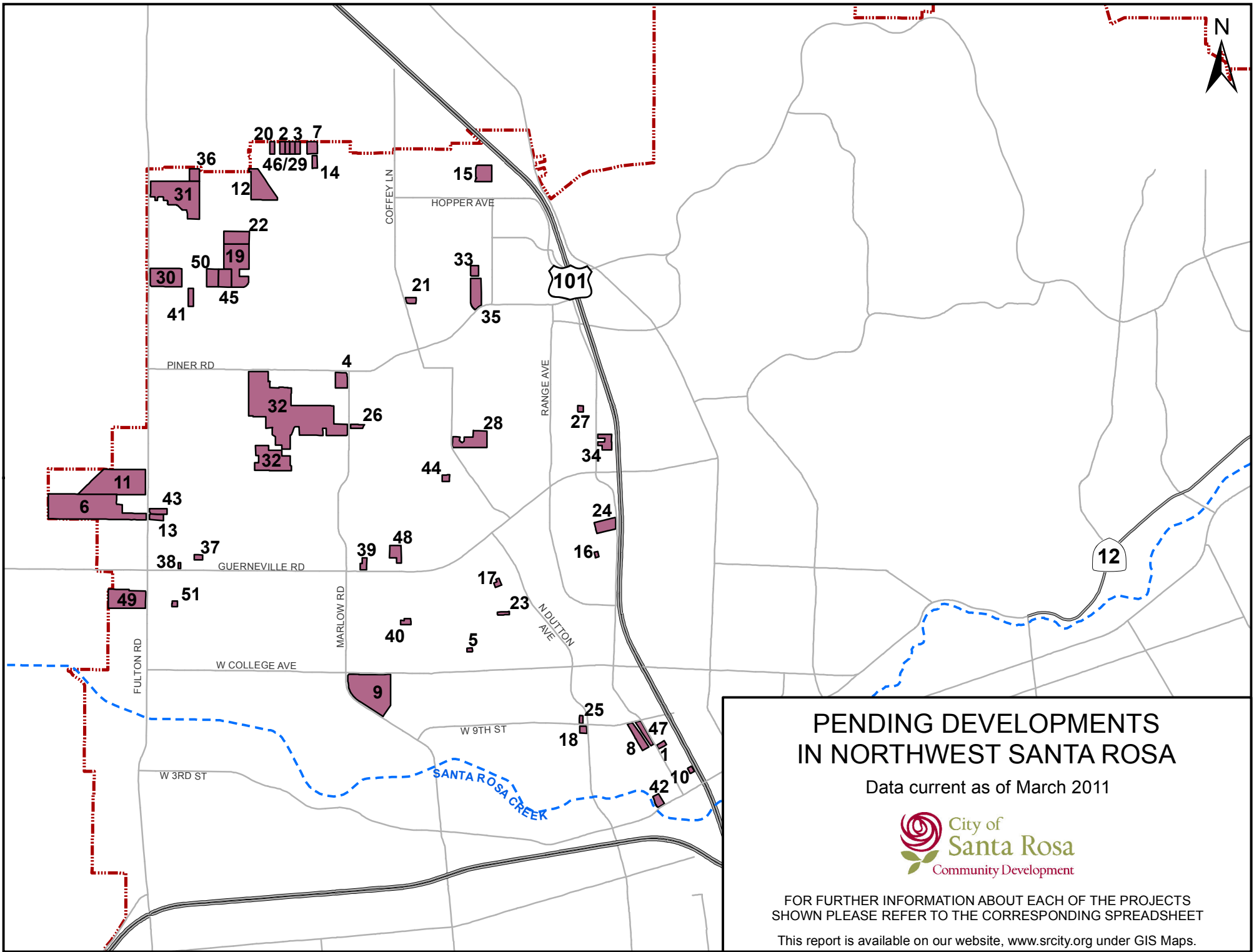

PENDING DEVELOPMENTS IN NORTHWEST SANTA ROSA

Data current as of March 2011



FOR FURTHER INFORMATION ABOUT EACH OF THE PROJECTS
SHOWN PLEASE REFER TO THE CORRESPONDING SPREADSHEET
This report is available on our website, www.srcity.org under GIS Maps.

City of Santa Rosa Department of Community Development

SUMMARY OF PENDING DEVELOPMENTS IN SOUTHEAST QUADRANT

June 2011

Southeast Quadrant

Residential (Units)	Pending	Approved
Single-Family Detached	9	350
Single-Family Attached	20	378
Live / Work	0	0
Multi-Family	93	283
Second Units	0	0
Senior Units	118	0
Total:	240	1,011

Non-Residential (Sq Ft)	Pending	Approved
Retail	4,962	98,500
Office	114,100	0
Light Industrial	0	0
Industrial	0	0
Public / Institutional	0	10,564
Total:	119,062	109,064

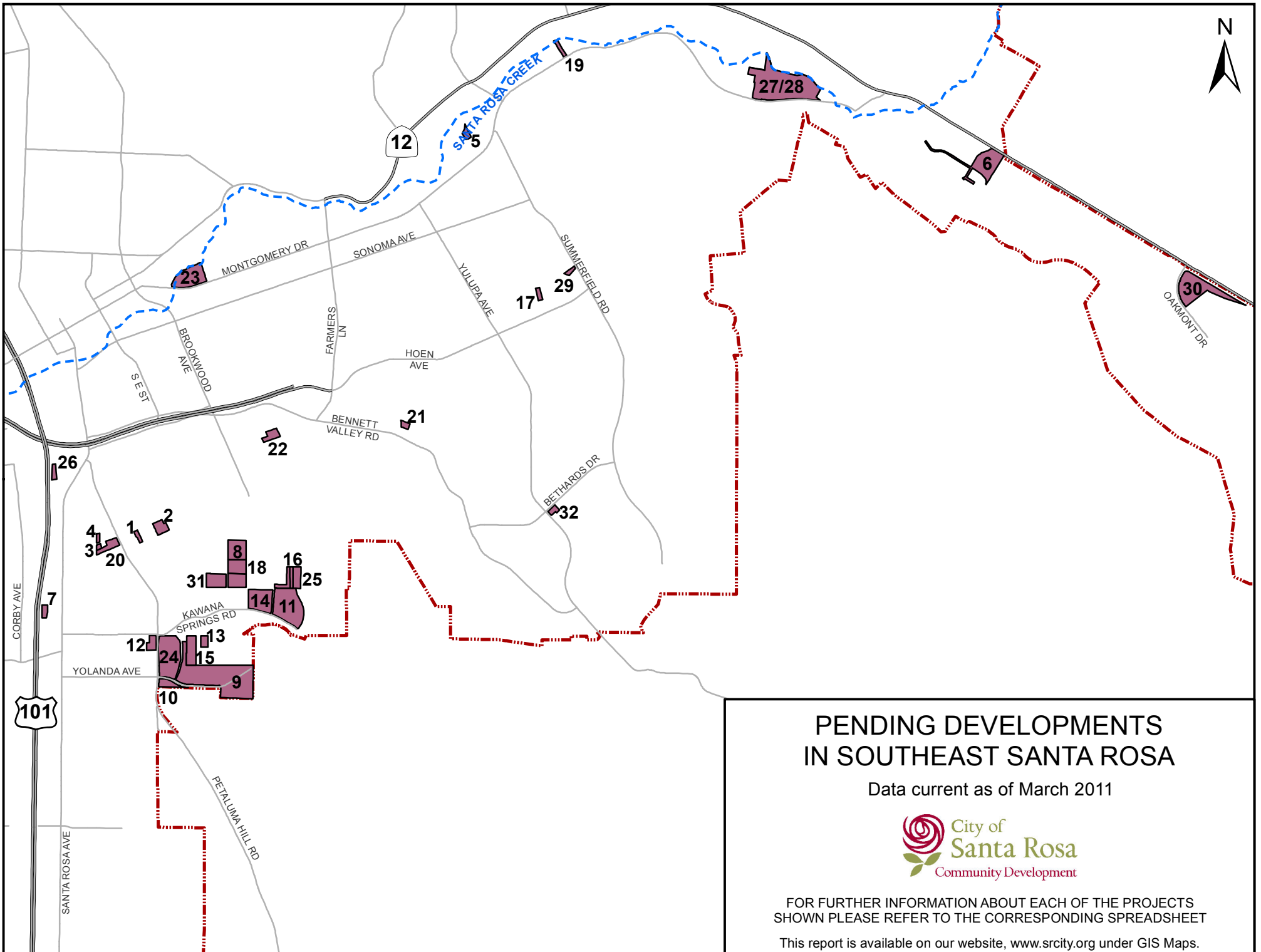

PENDING DEVELOPMENTS IN SOUTHEAST SANTA ROSA

Data current as of March 2011



FOR FURTHER INFORMATION ABOUT EACH OF THE PROJECTS SHOWN PLEASE REFER TO THE CORRESPONDING SPREADSHEET

This report is available on our website, www.srcity.org under GIS Maps.

City of Santa Rosa Department of Community Development

SUMMARY OF PENDING DEVELOPMENTS IN SOUTHWEST QUADRANT

June 2011

Southwest Quadrant

Residential (Units)	Pending	Approved
Single-Family Detached	74	804
Single-Family Attached	75	466
Live / Work	0	0
Multi-Family	198	214
Second Units	4	86
Senior Units	0	0
Total:	351	1,570

Non-Residential (Sq Ft)	Pending	Approved
Retail	9,913	20,677
Office	0	0
Light Industrial	0	35,780
Industrial	0	0
Public / Institutional	0	0
Total:	9,913	56,457

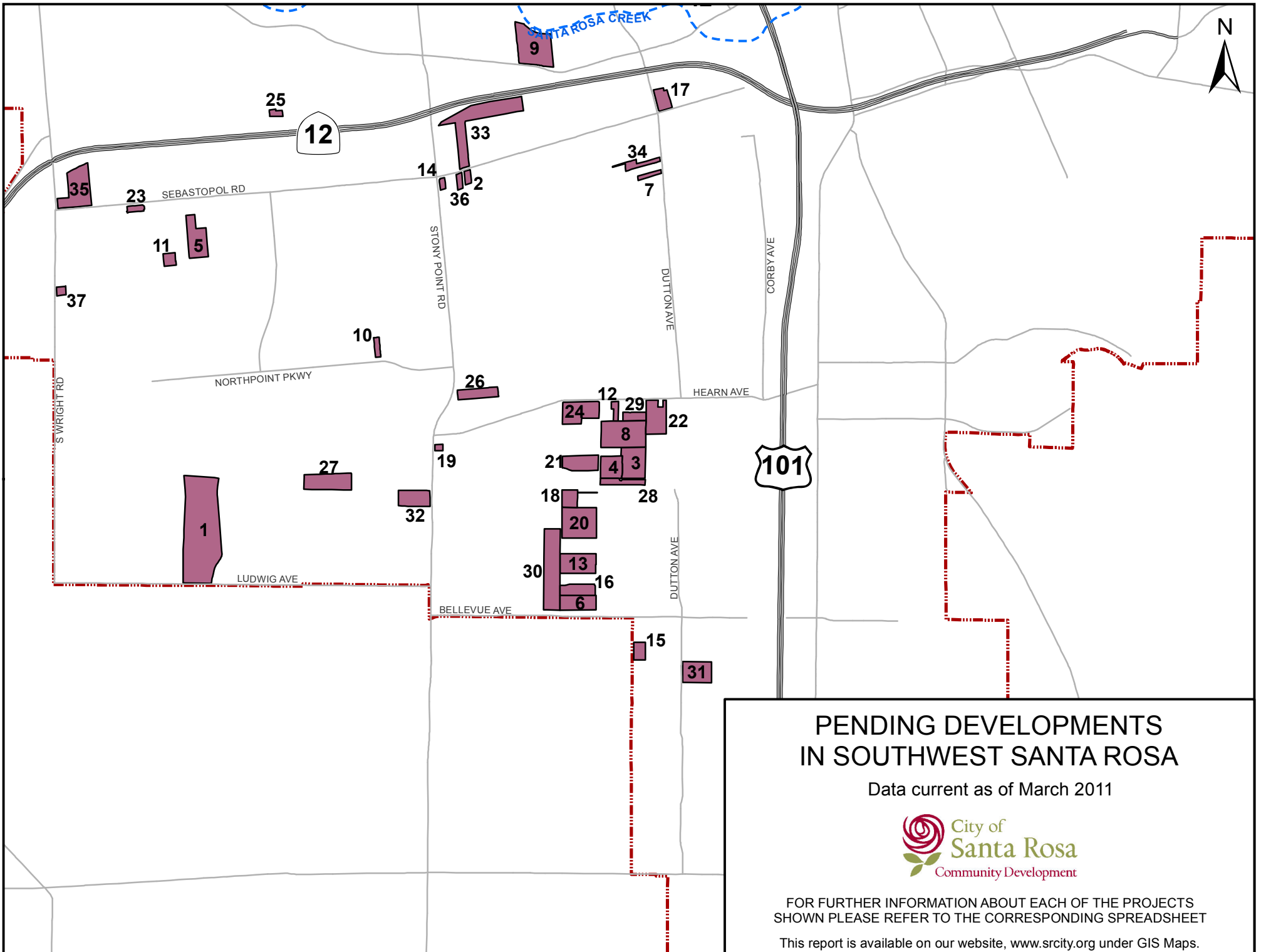

PENDING DEVELOPMENTS IN SOUTHWEST SANTA ROSA

Data current as of March 2011



FOR FURTHER INFORMATION ABOUT EACH OF THE PROJECTS SHOWN PLEASE REFER TO THE CORRESPONDING SPREADSHEET

This report is available on our website, www.srcity.org under GIS Maps.

PENDING DEVELOPMENT REPORT

Wednesday, June 15, 2011

NO.	FILE NO.	ADDRESS	PROJECT NAME/APPLICANT	TYPE OF ACTIVITY	ACRES	TYPE AND UNITS	STATUS	PLANNER
Northeast								
1	MNP09-025	499 Humboldt St 670 7th St	499 Humboldt/670 Seventh St Futrell Corp and Burbank Housing 200 Fourth St Suite 250 Santa Rosa, CA 95401 na		0.39	51 Units - MF	Approved	Rose
2	MNP05-058	700 Third St 100 D St	700 3rd Street Monahan Pacific Corp. 1101 5th Ave Suite 300 San Rafael, CA 94901 (415) 456-0600	Design Review	0.53	114,110 Sq Ft - OFC 13,700 Sq Ft - RET	Proposed	Rose
3	MJP07-046	888 Fourth St	888 Fourth St Hugh Futrell Corporation 200 Fourth St Suite 250 Santa Rosa, CA 95401 (707) 568-3482	Major Subdivision Conditional Use Permit Design Review Rezoning	0.76	52 Units - SFA 4,269 Sq Ft - RET	Approved	Morris
4	MAJ07-017	660 Acacia Ln 664 Acacia Ln	Acacia East Farid Traboulsi Tr Et Al PO Box 14517 Santa Rosa, CA 95402 (707) 577-0425	Major Project Conditional Use Permit	7.95	5 Units - SFD	Approved	Jones
5	MNP09-019	657 Acacia Ln	Acacia Lane Senior Apartments Petaluma Ecumenical Properties 951 Petaluma Blvd South Petaluma, CA 94952 (707) 762-2336	Design Review Density Increase	1.32	43 Senior Units 1 MF Unit	Approved	Morris

NO.	FILE NO.	ADDRESS	PROJECT NAME/APPLICANT	TYPE OF ACTIVITY	ACRES	TYPE AND UNITS	STATUS	PLANNER
6	MJP03-010	5490 Sonoma Hwy	Annadel Estates Hall Family Ltd. PTP % Kevin Hall PO Box 538 Penngrove, CA 94951 (707) 538-6061	Major Subdivision Ext.	7.1	10 Units - SFD	Approved	Jones
7	MJP07-043	620 7th St	Art House Hugh Futrell Corp 200 4th St Suite 250 Santa Rosa, CA 95401 (707) 568-3482	Major Subdivision Conditional Use Permit Design Review	0.2	21 Units - SFA 2,005 Sq Ft - RET	Approved	Morris
8	CUP10-023	3555 Sonoma Hwy	Athena House Residential Treatment Program California Human Development 3315 Airway Dr Santa Rosa, CA 95403 (707) 523-1155	Conditional Use Permit			Approved	Rose
9	MJP10-003	3366 Mendocino Ave	Bicentennial Marketplace AVB Development Partners 7316 E 6th Ave Phoenix, AZ 85251 (480) 429-7600	Major Project Rezoning	10.4	40,000 Sq Ft - RET	Proposed	Rose
10	MAJ01-017	199 Calistoga Rd	Calistoga Grove Clement & Ann Marie Carnalli 520 Mendocino Ave Suite 250 Santa Rosa, CA 95401 (707) 579-0111	Major Subdivision	0.91	6 Units - SFD	Approved	Jones
11	MJP05-016	5184 Sonoma Hwy 5181 Sonoma Hwy	Calistoga Village TDG Consulting Civil Engineers 3289 Regional Pkwy Santa Rosa, CA 95403 (707) 577-0425	Major Project	2.13	17 Units - SFD	Approved	File

NO.	FILE NO.	ADDRESS	PROJECT NAME/APPLICANT	TYPE OF ACTIVITY	ACRES	TYPE AND UNITS	STATUS	PLANNER
12	MJP10-002	2327 Chanate Rd	Chanate Cottages Yulia V Lopatyuk 65 El Cerrito Ave San Mateo, CA 94402 na	Major Project	1.16	18 Units - MF	Proposed	Morris
13	MNP02-047	3319 Chanate Rd 3321 Chanate Rd	Chanate Medical Center Phase 2 William H. Knight 811 Third St Santa Rosa, CA 95404 (707) 528-4044	Minor Project Conditional Use Permit	4.65	34,000 Sq Ft - OFC	Approved	File
14	MJP06-006	620 Third St	Comstock Mall Mixed Use 620 Third Street LLC 250 A Bel Marin Keys Novato, CA 94949 (415) 456-8972	Design Review Gen. Plan Amendment Rezoning	0.59	116 Units - SFA 8,403 Sq Ft - RET	Approved	File
15	MJP06-044	101 Elliott Ave	Elliott Condominiums Sola Santa Rosa LLC 22130 W Lyndon Loop Castro Valley, CA 94552 (510) 693-8867	Condo Conversion	0.64	28 Units - CNV	Proposed	File
16	MJP04-041	3700 Fir Ridge Drive	Fir Ridge Workforce Housing Santa Rosa School District/ Doug Bower 211 Ridgway Avenue Santa Rosa, CA 95401 (707) 528-5388	Major Subdivision	6.03	36 Units - SFA	Approved	File
17	MNP01-017	3558 Round Barn Cir	Fountaingrove Executive Center Bruce Aspinall & Associates 703 2nd St Suite 200 Santa Rosa, CA 95404 (707) 526-1111	Minor Project Conditional Use Permit Ext Design Review	4.58	209,000 Sq Ft - OFC	Approved	File

NO.	FILE NO.	ADDRESS	PROJECT NAME/APPLICANT	TYPE OF ACTIVITY	ACRES	TYPE AND UNITS	STATUS	PLANNER
18	MAJ05-033	3586 Mendocino Ave	Fountaingrove Inn Condos Fountaingrove Inn LLC/Ken Murakami 101 Fountaingrove Parkway Santa Rosa, CA 95403 (707) 578-6101	Major Subdivision Design Review Conditional Use Permit Rezoning	2.92	22 Units - SFA	Approved	Hartman
19	MJP06-041	4110 Thomas Lake Harris Dr	Fountaingrove Lodge Aegis Senior Living/Steve McCullagh 220 Concourse Blvd Santa Rosa, CA 95403 (707) 535-3200	Major Project Hillside Dev Permit Conditional Use Permit Design Review	22.37	136 Units - SNR 12 Units - MF	Approved	Morris
20	MNP04-002	5680 Sonoma Hwy	Hope Chapel ICFG Hope Chapel Bldg Team 5680 Sonoma Hwy/Dan Boyd Santa Rosa, CA 95409 (707) 539-4673	Minor Project Design Review Conditional Use Permit	2	22,570 Sq Ft - PUB/INST	Approved	Jones
21	MAJ05-009	4343 Sonoma Hwy	Kylie Lane Tuxhorn Melvin Jr Tr & Elizabeth A Tr PO Box 11128 Santa Rosa, CA 95406 (707) 569-0300	Major Subdivision	0.92	12 Units - SFA	Approved	File
22	MJP07-020	2075 Mendocino Ave	Longs Remodel & Shop Addition Longs Drugs California Inc/Joe Cavanagh 141 North Civic Drive Walnut Creek, CA 94596 (925) 269-7919	Conditional Use Permit Rezoning	3.28	6,000 Sq Ft - RET	Approved	Hayes
23	MJP07-023	225 Indian Creek Dr 227 Indian Creek Dr	Los Indios Subdivision Kevin Investment Co. 520 Mendocino Ave Suite 250 Santa Rosa, CA 95401 (707) 579-0111	Major Project Conditional Use Permit	1.63	12 Units - SFD	Approved	Rose

NO.	FILE NO.	ADDRESS	PROJECT NAME/APPLICANT	TYPE OF ACTIVITY	ACRES	TYPE AND UNITS	STATUS	PLANNER
24	MJP06-047	117 Middle Rincon Rd	Middle Rincon Subdivision Elizabeth Fisher Tr 117 Middle Rincon Rd Santa Rosa, CA 95409 (707) 540-9292	Major Subdivision Conditional Use Permit	0.91	5 Units - SFD	Approved	Housh
25	DR05-009	528 B St	MKG Office Building Morrison Karsten Group 528 B St Santa Rosa, CA 95401 (707) 575-9416	Design Review	0.19	17,210 Sq Ft - OFC	Approved	Hartman
26	MNP10-021	6599 Montecito Blvd	Montecito Marketplace RPS Montecito LLC 2296 Santa Rosa Ave Santa Rosa, CA 95407 (707) 326-8033	Minor Project	.61	6,247 Sq Ft - RET	Proposed	Morris
27	MAJ05-018	6600 Montecito Blvd	Montecito Pines Kellogg & Associates 50 Santa Rosa Ave Suite 400 Santa Rosa, CA 95404 (707) 570-1160	Design Review Conditional Use Permit	3.92	76 Units - CNV	Approved	Jones
28	MJP06-012	1265 Morgan St 232 Ridgway Ave	Morgan Street Townhomes Ryan & Sheri Neuman 631 First St Suite B Santa Rosa, CA 95404 (707) 878-7098	Major Subdivision Design Review	0.48	6 Units - SFA	Proposed	File
29	DR10-049	520 3rd St	Museum on the Square Santa Rosa Redevelopment Agency 90 Santa Rosa Ave Santa Rosa, CA 95404 na	Design Review	.58	43 Units -MF 65,896 - OFC	Approved	Rose

NO.	FILE NO.	ADDRESS	PROJECT NAME/APPLICANT	TYPE OF ACTIVITY	ACRES	TYPE AND UNITS	STATUS	PLANNER
30	MJP06-020	4599 Sonoma Hwy 4607 Sonoma Hwy 4617 Sonoma Hwy	Prospect Oaks Subdivision Prospect Oaks LLC/Kurt Setzer 1270 Panorama Drive Lafayette, CA 94549 (415) 845-7500	Major Subdivision Design Review	3.01	32 Units - SFA	Approved	Hayes
31	MJP08-008	807 Acacia Ln 810 Acacia Ln	Prospect Village #2 Kane et al PO Box 14517 Santa Rosa, CA 95402 (707) 577-0425	Conditional Use Permit Rezoning	1.81	12 Units - SFD	Approved	Jones
32	MAJ05-028	745 Acacia Lane 705 Acacia Lane	Saraceni Village Richard & Teresa Saraceni 705 Acacia Ln Santa Rosa, CA 95409 (707) 530-0879	Major Project Conditional Use Permit	1.34	6 Units - SFD 1 Unit - SCND	Approved	Hartman
33	MJP05-035	3925 Saint Andrews Dr	Skyfarm 3 Andremer Developers 1301 Farmers Ln Suite 203 Santa Rosa, CA 95405 unknown	Major Project Conditional Use Permit Hillside Dev Permit	10.44	30 Units - SFD	Proposed	Morris
34	MIN06-010	737 Slater St 741 Slater St	Slater Street Houses Marovich Homes PO Box 4056 Santa Rosa, CA 95406 unknown	Minor Project Conditional Use Permit Rezoning	0.38	5 Units - MF	Approved	Jones
35	MJP09-003	1521 Fountaingrove Pkwy	Terrazzo at Fountaingrove CGF Equities Carl Gobar Futrell LLC 200 4th Street Suite 250 Santa Rosa, CA 95401 unknown	Major Project Hillside Dev Permit Conditional Use Permit Design Review	7.5	55 Units - SFA	Proposed	Morris

NO.	FILE NO.	ADDRESS	PROJECT NAME/APPLICANT	TYPE OF ACTIVITY	ACRES	TYPE AND UNITS	STATUS	PLANNER
36	MJP07-016	3500 Lake Park Dr	The Arbors Chamberlain Lake Park LLC 655 Skyway #230 San Carlos, CA 94070-2711 (650) 595-5582	Major Subdivision Design Review Conditional Use Permit Hillside Dev Permit	5.69	37 Units - SFD	Approved	Morris
37	MJP07-007	5150 Sonoma Hwy	Vista Gabrielle Gabrielle & Jalal Saad Tr Et Al 2601 Mountain Gate Way Oakland, CA 94611 unknown	Major Project Rezoning Design Review Conditional Use Permit	0.5	5 Units - SFD	Approved	Rose

Northwest

1	MNP07-003	120 8th St 122 8th St 614 Wilson St	8th and Wilson Building Dan & Christen Schieberi 1905 San Miguel Road Santa Rosa, CA 95403 unknown	Conditional Use Permit Design Review	0.45	18 Units - MF 6,000 Sq Ft - RET	Proposed	Rose
2	REZ06-017	2129 Dennis Ln	Auberge Du Soleil Carco Investments 520 Mendocino Ave Suite 250 Santa Rosa, CA 95401 (707) 579-0111	Major Subdivision Conditional Use Permit Rezoning	1	8 Units - SFD	Approved	Jones
3	MAJ07-014	2113 Dennis Ln	Auberge Du Soleil 2 Farrell, Faber & Associates 1022 Mendocino Ave Santa Rosa, CA 95401 (707) 579-3811	Major Project Conditional Use Permit Rezoning	1	7 Units - SFD	Approved	Jones
4	MNP07-020	2000 Piner Rd	BREP Center Bismark Dev Co LLC 135 East 57th St Flr 15 New York, NY 10022 (212) 618-8778	Conditional Use Permit Design Review Zoning Variance	2.93	4,900 Sq Ft - RET	Proposed	File

NO.	FILE NO.	ADDRESS	PROJECT NAME/APPLICANT	TYPE OF ACTIVITY	ACRES	TYPE AND UNITS	STATUS	PLANNER
5	MAJ04-040	1137 Clover Dr	Clover Drive Townhomes Vihjay P Khiroya PO Box 382 Guerneville, CA 95446 (707) 538-0377	Major Project Conditional Use Permit Design Review	0.34	5 Units - SFA	Approved	File
6	MJP04-029	1549 Fulton Rd	Courtney Estates Ingenium Inc 2450 Summit Drive Santa Rosa, CA 95404 (707) 578-1680	Major Subdivision Rezoning	31.75	47 Units - SFD 10 Units - MF	Approved	Hartman
7	MJP05-049	2063 Dennis Lane 2055 Dennis Lane 3804 Elwin Lane	Dennis Lane Subdivision Stephen & Marilynn Liner 2063 Dennis Ln Santa Rosa, CA 95403 (707) 544-6673	Major Subdivision Conditional Use Permit Rezoning	2	16 Units - SFD	Approved	Jones
8	MJP06-017	8 West 9th St 806 Donahue St	DeTurk Winery Village RR Sq Vlg LLC/R. Deringer PO Box 706 Tiburon, CA 94920 (707) 310-2291	Major Subdivision Conditional Use Permit Design Review Rezoning	3.01	73 Units - SFA	Approved	Rose
9	MNP07-014	2060 West College Ave	Finley Center Senior Wing Addition Seniors Inc./Kurt Wheeling 445 Orchard Santa Rosa, CA 95404 (707) 636-2251	Conditional Use Permit Design Review	22.48	24,408 Sq Ft - PUB/INST	Approved	Housh
10	MJP06-040	210 Fifth St	Fourth and Davis Fourth and Davis LLC 200 4th St Suite 200 Santa Rosa, CA 95401 (707) 568-3482	Major Subdivision Conditional Use Permit	0.52	43,700 Sq Ft - OFC 7,592 Sq Ft - RET	Approved	Rose

NO.	FILE NO.	ADDRESS	PROJECT NAME/APPLICANT	TYPE OF ACTIVITY	ACRES	TYPE AND UNITS	STATUS	PLANNER
11	MJP06-048	1615 Fulton Rd	Fox Hollow Carco Investment Corp 520 Mendocino Ave Suite 250 Santa Rosa, CA 95401 (707) 578-1302	Major Subdivision Conditional Use Permit	22.7	171 Units - SFD 14 Units - MF	Approved	Hines
12	MAJ07-018	2318 Francisco Ave	Francisco Village Carco Investments 520 Mendocino Ave Santa Rosa, CA 95403 (707) 693-8588	Major Subdivision Conditional Use Permit Rezoning	9.28	74 Units - SFD	Proposed	Housh
13	MJP06-026	1530 Fulton Rd	Fulton Oaks Homecoming Dev/Ross Albertson 3250 A Dutton Ave Santa Rosa, CA 95407 (707) 578-3933	Major Subdivision Conditional Use Permit Rezoning	1.32	10 Units - SFD	Approved	Hartman
14	MJP07-027	2056 Dennis Ln	Harry's Village Harry D Sonnikson Tr 3830 Elwin Ln Santa Rosa, CA 95403 (707) 577-0425	Major Subdivision Conditional Use Permit Rezoning	1	8 Units - SFD	Proposed	Jones
15	MNP08-029	3731 Airway Dr	Holiday Inn Express Hotel and Suites Pitamber Ramesh 5151 Weston Way Granite Bay, CA 95476 (916) 786-9223	Minor Project Design Review Zoning Variance	4.49	143 Rooms	Proposed	Rose
16	MJP06-009	889 Jennings Ave	Jennings Ave Phase II Main Street Place Corp 139 Yulupa Cir Santa Rosa, CA 95405 (707) 573-5941	Major Subdivision Design Review Rezoning	0.4	6 Units - SFA	Proposed	Morris

NO.	FILE NO.	ADDRESS	PROJECT NAME/APPLICANT	TYPE OF ACTIVITY	ACRES	TYPE AND UNITS	STATUS	PLANNER
17	MAJ06-035	1215 & 1217 Jennings Ave	Jennings Ave Subdivision Sonoma Marin Construction PO Box 2775 Petaluma, CA 94953 (707) 763-6981	Major Subdivision Rezoning Conditional Use Permit	0.64	5 Units - SFD	Approved	File
18	MJP04-049	824 N Dutton Ave	Keaney Subdivision Anne and Kieran Keaney 146 Purrington Rd Petaluma, CA 94952 (707) 769-1996	Major Subdivision	0.77	6 Units - SFD 2 Units - SCND	Approved	File
19	MJP05-053	2181 Francisco Avenue 2191 Francisco Avenue 2193 Francisco Avenue	Kerry Ranch Kerry Ranch LLC 336 Bon Air Center, Box 115 Greenbrae, CA 94904 (415) 472-1086	Major Subdivision Rezoning Vacation RoW	13.96	95 Units - SFD 41 Units - SCND	Approved	Hayes
20	MJP06-052	2153 Dennis Lane	Labaree Subdivision Jon & Lexine Labaree 2153 Dennis Ln Santa Rosa, CA 95403 (707) 527-6615	Major Subdivision Conditional Use Permit Rezoning	1	8 Units - SFD	Proposed	Hartman
21	MJP04-035	3364 Coffey Lane	Lands of Furia Dennis Furia 3364 Coffey Lane Santa Rosa, CA 95403 (707) 577-0425	Major Subdivision Rezoning	1	7 Units - SFD	Approved	Hartman
22	MJP07-059	2225 Francisco Ave	Leras Village Michael Leras 2225 Francisco Ave Santa Rosa, CA 95403 unknown	Major Subdivision Conditional Use Permit Rezoning	5.22	41 Units - SFD	Proposed	Hayes

NO.	FILE NO.	ADDRESS	PROJECT NAME/APPLICANT	TYPE OF ACTIVITY	ACRES	TYPE AND UNITS	STATUS	PLANNER
23	MJP06-005	1625 Eardley Ave	Liang Subdivision Kevin Liang 1531 Sunview Ct Santa Rosa, CA 95401 (707) 328-4626	Minor Project Rezoning Conditional Use Permit	0.58	3 Units - SFD 3 Units - SCND	Approved	Housh
24	MJP08-005	1975 Cleveland Ave	Los Robles Residential Bayrock Residential/Stuart Gruendi 1300 Clay St Suite 620 Oakland, CA 94612 (510) 873-8880	Major Project Conditional Use Permit Design Review	3.54	102 Units - SFA	Proposed	Morris
25	MNP07-005	385 West 9th St	Lozano Automotive Services Adam Lozano 905 North Dutton Ave Santa Rosa, CA 95401 (707) 545-3570	Conditional Use Permit Design Review	0.47	6,835 Sq Ft - IND	Approved	Housh
26	MAJ07-011	3018 Marlow Rd	Marlow Mews TDG Consulting Civil Engineers 3289 Regional Pkwy Santa Rosa, CA 95403 (707) 577-0425	Major Subdivision Annexation Conditional Use Permit Rezoning	0.79	11 Units - SFD	Approved	Housh
27	MAJ07-022	2760 McBride Ln	McBride Condominiums Joseph Perry Tr Et Al 885 Olive Ave Suite C Novato, CA 94945 (415) 892-1679	Condo Conversion	0.54	12 Units - CNV	Approved	Rose
28	MAJ06-026	1598 Becky Ct	Meadowrock Condos Pine Creek Propoerties/Ken Martin PO Box 11218 Santa Rosa, CA 95406 (707) 578-1125	Condo Conversion	6.25	104 Units - CNV	Approved	Hartman

NO.	FILE NO.	ADDRESS	PROJECT NAME/APPLICANT	TYPE OF ACTIVITY	ACRES	TYPE AND UNITS	STATUS	PLANNER
29	MAJ07-015	2121 Dennis Ln	Miller Village TDG Consulting Civil Engineers 3289 Regional Pkwy Santa Rosa, CA 95403 (707) 577-0425	Major Project Conditional Use Permit Rezoning	1	8 Units - SFD	Approved	Jones
30	MJP03-014	2108 Fulton Rd 2160 Fulton Rd	Montage II Rivendale Communities/Chris Peterson PO Box 2217 Santa Rosa, CA 95405 (707) 525-1358	Major Subdivision Rezoning	9.16	51 Units - SFD 51 Units - MF	Approved	File
31	MJP07-003	2406 Fulton Rd	North Village 2 Fulton Road Investors 200 Fourth St Suite 250 Santa Rosa, CA 95401 (707) 568-3482	Major Subdivision Conditional Use Permit Design Review	18.1	112 Units - SFA	Proposed	Housh
32	ANX07-004	2200 Piner Rd	NWSR 2-07 Barbara Kringle TR 111 Jonagold Wy Brentwood, CA 94513 unknown	Annexation	10.41	10.44 Acres	Proposed	Housh
33	DR09-040	3300 Industrial Dr	O Rourke Electric Daniel & Rosanne O Rourke 2130 Smoketree Ct Santa Rosa, CA 95403 (707) 528-8539	Design Review	1.28	25,558 Sq Ft - LI	Approved	Morris
34	DR07-077	2230 Cleveland Ave	Orchard Supply Red Mountain Retail Grp 1234 17th St Santa Ana, CA 92701 (714) 460-1552	Design Review	2.74	6,000 Sq Ft - RET	Proposed	Hayes

NO.	FILE NO.	ADDRESS	PROJECT NAME/APPLICANT	TYPE OF ACTIVITY	ACRES	TYPE AND UNITS	STATUS	PLANNER
35	CUP09-055	1201 Piner Road	Palm Square Pine Creek Properties PO Box 11218 Santa Rosa, CA 95406 (707) 578-1125	Conditional Use Permit	0	10,000 sq ft RET	Approved	Rose
36	MJP05-025	2407 Francisco Ave	Paseo at Francisco Carco Investments/ Kevin Carinalli 520 Mendocino Ave Suite 250 Santa Rosa, CA 95401 (707) 579-4102	Major Subdivision	2.02	16 Units - SFD	Proposed	Housh
37	MJP07-022	1483 Peterson Ln	Peterson Lane Subdivision Daniel R. Brown 2323 Bethards Dr Santa Rosa, CA 95405 (707) 576-7000	Major Project Rezoning Conditional Use Permit	0.75	5 Units - SFD	Approved	Morris
38	MJP05-002	2453 Guerneville Rd	Quilici Subdivision David Colombo 804 College Ave Santa Rosa, CA 95402 (707) 328-1224	Major Project Design Review Rezoning	0.22	7 Units - MF	Approved	Galbraith
39	MJP06-022	1755 Guerneville Rd	Ravello Homecoming Dev LLC/Ross Albertson 3250-A Dutton Ave Santa Rosa, CA 95407 (707) 578-3933	Major Subdivision Design Review Conditional Use Permit Rezoning	1.06	13 Units - SFA	Approved	Hayes
40	MJP07-061	1550 Ridley Ave	Ridley Village Farid Traboulsi Trust PO Box 14517 Santa Rosa, CA 95402 (707) 494-0425	Major Subdivision Conditional Use Permit	1.05	8 Units - SFD	Proposed	Rose

NO.	FILE NO.	ADDRESS	PROJECT NAME/APPLICANT	TYPE OF ACTIVITY	ACRES	TYPE AND UNITS	STATUS	PLANNER
41	MJP07-005	2390 San Miguel Ave	San Miguelito Carco Investments Corp 520 Mendocino Ave Suite 250 Santa Rosa, CA 95401 (707) 579-0111	Major Subdivision Conditional Use Permit Rezoning Annexation	1.56	12 Units - SFD	Proposed	Morris
42	MAJ08-010	3 West Third St	Santa Rosa Cannery Santa Rosa Cannery LLC/John Stewart 1388 Sutter St., 11th Floor San Francisco, CA 94104 (415) 345-4400	Major Project Design Review Conditional Use Permit	1.32	93 Units - SFA	Approved	Rose
43	MJP06-031	1552 Fulton Rd	Spring Brook Carco Investments/Kevin Carinalli 520 Mendocino Ave Suite 250 Santa Rosa, CA 95401 (707) 579-0111	Major Subdivision Conditional Use Permit Rezoning	1.56	12 Units - SFD	Approved	Jones
44	MAJ03-010	2300 W Steele Ln	Steele Lane Cottages TDG Consulting Civil Engineers 3289 Reginal Pkwy Santa Rosa, CA 95403 (707) 526-1111	Major Subdivision	0.76	6 Units - SFD	Approved	Hartman
45	MJP 07-001	2245 San Miguel Ave 2271 San Miguel Ave	Tapestry Centennial Homes 2 Ranch Road Novato, CA 94945 (415) 899-1962	Major Subdivision Conditional Use Permit Design Review Rezoning	3.73	29 Units - SFD 5 Units - SCND	Approved	Hayes
46	MAJ07-013	2137 Dennis Ln	Weller Subdivision Clement & Ann Marie Carinalli 520 Mendocino Ave Suite 250 Santa Rosa, CA 95401 (707) 696-8588	Major Subdivision Conditional Use Permit Rezoning	1	8 Units - SFD	Approved	Jones

NO.	FILE NO.	ADDRESS	PROJECT NAME/APPLICANT	TYPE OF ACTIVITY	ACRES	TYPE AND UNITS	STATUS	PLANNER
47	MJP07-040	701 Wilson St	West End Village West End Village LLC/Richard Deringer PO Box 706 Tiburon, CA 94920 (707) 310-2291	Major Subdivision Conditional Use Permit Design Review	1.83	45 Units - SFD 4,738 Sq Ft - RET	Approved	Rose
48	MJP06-018	1801 Ridley Ave	Westborough Homecoming Dev/Ross Albertson 3250-A Dutton Ave Santa Rosa, CA 95407 (707) 578-3933	Major Project Rezoning Gen. Plan Amendment	2.61	35 Units - SFA	Approved	Hayes
49	MNP07-017	1287 Fulton Rd 2598 Guerneville Rd 1265 Fulton Rd	Westside Health Care Campus Knight Wagner/ Wm Knight PO Box 549 Santa Rosa, CA 95402 (707) 539-0337	Conditional Use Permit Design Review	11.94	49,250 Sq Ft - PUB/INST	Proposed	Morris
50	MJP05-043	2321 San Miguel Ave 2285 San Miguel Ave	Wildflower Shook and Waller Builders Inc 3250-A Dutton Ave Santa Rosa, CA 95407 (707) 578-3933	Major Subdivision	3.47	27 Units - SFD	Approved	Hayes
51	ANX07-007	1395 Velma Ave	Young Village Annexation Juliana B Young Tr 10 Warrens Wy Tiburon, CA 94920 unknown	Annexation Rezoning	0.39	0.39 Acres	Proposed	File

Southeast

1	MJP04-019	706 Aston Ave 708 Aston Ave	Aston Ave Duplex Apartments Aston Ave Dev LLC/Syd Kelly 1400 N Dutton Ave Santa Rosa, CA 95401 (707) 578-3057	Major Project Design Review Rezoning Conditional Use Permit	1.86	28 Units - MF	Approved	Morris
---	-----------	--------------------------------	--	--	------	---------------	----------	--------

NO.	FILE NO.	ADDRESS	PROJECT NAME/APPLICANT	TYPE OF ACTIVITY	ACRES	TYPE AND UNITS	STATUS	PLANNER
2	MJP04-005	908 Aston Ave 918 Aston Ave 922 Aston Ave	Aston Place Aston Place Partners, LLC 625 Second St Suite 102 Petaluma, CA 94952 (707) 283-0700	Major Subdivision Rezoning Design Review	2.72	33 Units - SFA	Approved	Hartman
3	MAJ04-046	532 Aston Wy	Aston Way Homes Jeff Stevenson/Adobe Enterprises 1501 Hopi Trail Santa Rosa, CA 95404 (707) 331-4443	Major Subdivision	0.47	13 Units - SFD 2 Units - SFA	Approved	File
4	MJP05-013	537 Aston Ave	Aston Way Townhomes Jeff Stevenson/Ron Herrerias 1501 Hopi Trail Santa Rosa, CA 95404 (707) 331-4443	Major Subdivision Design Review	0.49	7 Units - SFA	Approved	Hartman
5	MJP06-023	4023 Montgomery Dr	Bramble Rose Court James Hummer & Associates 703 Second St, Suite 200 Santa Rosa, CA 95404 (707) 526-1888	Major Subdivision Design Review	0.86	10 Units - SFA	Approved	File
6	MJP08-013	251 Elnoka Ln	Elnoka Village OSL Operations LLC 220 Concourse Blvd Santa Rosa, CA 95403 (707) 535-3200	Major Project Design Review Conditional Use Permit Density Increase	12.51	209 Units - SFA 4,962 Sq Ft - RET	Proposed	Morris
7	MNP08-006	111 Commerical Ct	Fairfield Inn and Suites Kar Hospitality LLC 1113 Airport Blvd San Francisco, CA 94080 (650) 873-9300	Conditional Use Permit Design Review	1.69	108 Rooms	Approved	Housh

NO.	FILE NO.	ADDRESS	PROJECT NAME/APPLICANT	TYPE OF ACTIVITY	ACRES	TYPE AND UNITS	STATUS	PLANNER
8	MJP05-048	1650 Meda Ave 1770 Meda Ave 1776 & 1800 Meda Ave	Glenview II Delco Bldrs & Developers 1372 N. McDowell Blvd Suite C Petaluma, CA 94954 (707) 766-1504	Major Project Rezoning	6.19	26 Units - SFD 4 Units - SFA	Approved	Housh
9	MAJ04-004	1162 Kawana Springs Rd 2660 Petaluma Hill Rd 2800 Petaluma Hill Rd	Kawana Meadows Clement Carinalli 520 Mendocino Ave Suite 250 Santa Rosa, CA 95401 (707) 578-1302	Major Subdivision Conditional Use Permit	43.74	69 Units - SFD 161 Units - MF	Approved	Hartman
10	DR05-155	2800 Kawana Spring Rd	Kawana Meadows Apts Clement Carinalli 520 Mendocino Ave Suite 250 Santa Rosa, CA 95401 (707) 578-1302	Design Review	2.31	30 Units - MF	Approved	Hartman
11	MAJ03-006	1835 Kawana Springs Rd	Kawana Springs 6 Kawana Springs, Inc./Phil Trowbridge 2880 Cleveland Ave #8 Santa Rosa, CA 95403 (707) 544-7059	Major Subdivision	30	94 Units - SFD	Approved	Hayes
12	MNP10-001	766 Kawana Springs Rd 786 Kawana Springs Rd	Kawana Springs Family Apartments USA Properties Fund Inc 2440 Professional Drive Roseville, CA 95661 (916) 724-3840	Minor Project Density Increase Design Review	2.04	42 Units - MF	Approved	Morris
13	MJP06-033	1346 Kawana Terrace	Kawana Terrace Carco Investments 520 Mendocino Ave Suite 250 Santa Rosa, CA 95401 (707) 579-0111	Major Project Conditional Use Permit	1.4	11 Units - SFD	Approved	File

NO.	FILE NO.	ADDRESS	PROJECT NAME/APPLICANT	TYPE OF ACTIVITY	ACRES	TYPE AND UNITS	STATUS	PLANNER
14	MAJ04-013	2450 Brookwood Ave	Kawana Town Center Kawana Town Center LLC PO Box 5260 Santa Rosa, CA 95402 (707) 544-7125	Major Subdivision	8.85	129 Units - SFA 10 Units - MF	Approved	File
15	MAJ05-025	1166 Kawana Terrace 1310 Kawana Springs Rd 1150 Kawana Springs Rd	Kawana Village Waterford Associates LLC 945 Front St Novato, CA 94945 (415) 898-6550	Major Project Design Review Conditional Use Permit	4.78	27 Units - SFD 12 Units - SFA	Approved	File
16	MJP07-062	2859 Linwood Ave	Linwood Village Carco Investments Inc 520 Mendocino Ave Suite 250 Santa Rosa, CA 95401 (707) 579-0111	Major Subdivision Conditional Use Permit	1.21	9 Units - SFD	Proposed	File
17	MAJ04-036	4352 Mayette Ave	Mayette Avenue Tentative Map Main Street Homes 139 Yulupa Circle Santa Rosa, CA 95405 (707) 573-5941	Major Subdivision Conditional Use Permit Rezoning	0.96	6 Units - SFD	Approved	Hartman
18	MJP06-025	1820 Meda Ave	Meda Village Blackstone Homes PO Box 6651 Santa Rosa, CA 95406 (707) 585-7400	Major Subdivision Conditional Use Permit Hillside Dev Permit Rezoning	4.6	30 Units - SFD	Approved	Hayes
19	MJP06-029	4743 Montgomery Dr	Montgomery Creek Montgomery Creek LLC PO Box 14517 Santa Rosa, CA 95402 (707) 577-0425	Major Subdivision Conditional Use Permit	1.15	6 Units - SFD	Approved	File

NO.	FILE NO.	ADDRESS	PROJECT NAME/APPLICANT	TYPE OF ACTIVITY	ACRES	TYPE AND UNITS	STATUS	PLANNER
20	DR04-151	1511, 1533 Petaluma Hill Rd 554 & 568 Aston Ave	Petaluma Hill Road Apartments Herand Der Sarkissian 220 Kenwood St Suite 320 Glendale, CA 91205 (818) 500-0415	Design Review	2.9	93 Units - MF	Proposed	Rose
21	MJP06-001	1649 Ronne Dr	Ronne Drive Subdivision Richard L Keith Tr 3843 Oak Glen Dr Santa Rosa, CA 95404 (707) 542-7605	Major Subdivision Rezoning	0.85	6 Units - SFD	Approved	Hayes
22	MJP05-026	1130 Gordon Ln	Sandalwood Carlile Macy/Curt Nichols 15 Third St Santa Rosa, CA 95405 (707) 542-6451	Major Subdivision Rezoning Conditional Use Permit	2.45	16 Units - SFD 2 Units - MF	Approved	File
23	MNP07-023	1165 Montgomery Dr	Santa Rosa Memorial Hospital Expansion St Joseph Health Systems/Wes Okamoto 1 Centerpoint 200 La Palma, CA 90623 (714) 347-7681	Conditional Use Permit Design Review	7.42	10,564 Sq Ft - PUB/INST	Approved	Morris
24	MJP 05-054	2660 Petaluma Hill Rd 2630 Petaluma Hill Rd 1072 Kawana Spring Rd	Santa Rosa Village Regency Alliance Santa Rosa LLC 1850 Mt. Diablo Blvd Suite 225 Walnut Creek, CA 94596 (925) 279-1760	Major Subdivision Design Review Rezoning Vacation Right of Way	14.6	126 Units - SFA 98,500 Sq Ft - RET	Approved	Hartman
25	ANX07-006	2795 Linwood Ave	SESR 2-07 Phillip & Lisa Natoli Tr 759 Jean Marie Dr Santa Rosa, CA 95403 (707) 292-4114	Annexation Prezoning	6.2	6.2 Acres	Approved	Jones

NO.	FILE NO.	ADDRESS	PROJECT NAME/APPLICANT	TYPE OF ACTIVITY	ACRES	TYPE AND UNITS	STATUS	PLANNER
26	MAJ05-007	965 South A St 983 South A St	South A Lofts South A Properties LLC/ James McCalligan 3000 Cleveland Suite 200 Santa Rosa, CA 95403 (707) 578-4525	Major Project Design Review Conditional Use Permit	1.16	20 Units - SFA	Proposed	Housh
27	MNP10-011	5435, 5445 Montgomery Dr 5447, 5555 Montgomery Dr Unknown Brey Rd	Spring Lake Village Episcopal Homes Foundation 2185 N California Blvd Suite 575 Walnut Creek, CA 94546 (925) 956-7373	Minor Project	31.42	62 Senior Units	Proposed	Rose
28	MNP07-025	5555 Montgomery Dr	Spring Lake Village Expansion Episcopal Homes Foundation 3650 Mt Diablo Blvd Suite 100 Lafayette, CA 94549 unknown	Conditional Use Permit Design Review Rezoning	30.37	56 Units - SNR	Proposed	Rose
29	MAJ07-031	2155 Summerfield Rd	Summerfield Road Condominiums Robert Benson 6040 Commerce Blvd Suite 104 Rohnert Park, CA 94928 (707) 206-0262	Condo Conversion	0.72	6 Units - CNV	Approved	Hayes
30	MJP06-036	6525 Oakmont Dr 6535 Oakmont Dr	The Meadows at Oakmont Clement & Anne Marie Carnalli 520 Mendocino Ave Suite 250 Santa Rosa, CA 95401 (707) 578-1302	Major Subdivision Conditional Use Permit	14.75	36 Units - SFD	Approved	File
31	MJP08-020	1865 Meda Ave 1846 Meda Ave	The Vistas at Kawana Springs Meda Avenue LLC PO Box 11068 Santa Rosa, CA 95406 unknown	Major Subdivision Conditional Use Permit Design Review Rezoning & Hillside Dev	9.6	10 Units - SFD 55 Units - SFA	Approved	Morris

NO.	FILE NO.	ADDRESS	PROJECT NAME/APPLICANT	TYPE OF ACTIVITY	ACRES	TYPE AND UNITS	STATUS	PLANNER
32	MNP06-006	2300 Bethards Dr	Valley Point Prof. Center Apts David & Ute Anderson PO Box 2830 Ventura, CA 93002 unknown	Minor Project Design Review Conditional Use Permit	1.05	10 Units - MF	Approved	Hayes

Southwest

1	MJP99-038	1301 Ludwig Ave	Air Center East Phase 2 Santa Rosa Assoc. II, % Industrial Realty 1091 Industrial Rd #101 San Carlos, CA 94070 (650) 592-5425	Major Subdivision Conditional Use Permit	37.11	133 Units - SFD	Approved	File
2	MNP04-030	1758 Sebastopol Rd	Alvarez Project Ignacio & Idolina Alvarez 443 Dutton Ave Suite 8 Santa Rosa, CA 95407 (707) 575-0560	Minor Project Design Review Conditional Use Permit	0.82	8 Units - MF 4,042 Sq Ft - RET	Approved	Hartman
3	MJP08-003	2740 Dutton Meadow	Amorosa Village Burbank Housing/Carrie Horton 790 Sonoma Avenue Santa Rosa, CA 95404 (707) 526-1020	Minor Project Conditional Use Permit Design Review	2	150 Units - MF	Approved	Morris
4	MJP08-003	2740 Dutton Meadow	Catalina Burbank Housing Development 790 Sonoma Avenue Santa Rosa, CA 95404 (707) 526-1020	Minor Project Conditional Use Permit Design Review	3	60 Units - SFA	Approved	Morris
5	MJP02-016	930 Fresno Ave	Cherry Ranch Cherry Ranch LLC % Harvey Rich 336 Bon Air Center, PO Box 132 Greenbrae, CA 94904 (415) 472-1086	Major Subdivision Rezoning	6.6	39 Units - SFD	Approved	Morris

NO.	FILE NO.	ADDRESS	PROJECT NAME/APPLICANT	TYPE OF ACTIVITY	ACRES	TYPE AND UNITS	STATUS	PLANNER
6	MJP03-022	3011 Dutton Meadow	Colgan Village TDG Consulting Civil Engineers 3289 Regional Pkwy Santa Rosa, CA 95403 (707) 577-0425	Major Subdivision Rezoning	5.36	65 Units - SFA	Approved	File
7	MJP07-037	895 Dutton Ave	Dutton Ave Subdivision Richard and Trisha Young 1077 Lakeville St Petaluma, CA 94952 (707) 763-6981	Major Subdivision Rezoning Conditional Use Permit	1.05	6 Units - SFD	Approved	Morris
8	MJP01-039	2650 Dutton Meadow 2666 Dutton Meadow 2684 Dutton Meadow	Dutton Meadows Phase 1 Trumark Companies 4185 Blackhawk Plaza Cir Suite 200 Danville, CA 94506 (925) 648-8300	Major Subdivision Conditional Use Permit	12	160 Units - SFD	Approved	File
9	MJP08-001	713 West Third St	Gardens Subdivision Cobblestone Homes Inc/ Frank Denney 1400 N. Dutton Ave Suite 24 Santa Rosa, CA 95401 (707) 528-8703	Major Subdivision Conditional Use Permit Design Review	10.23	82 Units - SFD	Approved	Morris
10	MJP06-050	2616 Giffen Ave	Giffen Avenue Subdivision Kristopher H & Leasa Graves 2616 Giffen Ave Santa Rosa, CA 95401 (707) 579-3922	Major Project Conditional Use Permit Rezoning	1.08	7 Units - SFD	Proposed	Rose
11	MJP01-024	1071 Fresno Ave	Golden Gate Court MEA Pacific III LP 825 Sonoma Ave #C Santa Rosa, CA 95404 (707) 544-0784	Major Subdivision Conditional Use Permit	1.93	12 Units - SFD 4 Units - SCND	Approved	Morris

NO.	FILE NO.	ADDRESS	PROJECT NAME/APPLICANT	TYPE OF ACTIVITY	ACRES	TYPE AND UNITS	STATUS	PLANNER
12	MAJ07-020	1466 Hearn Ave	Hearn Village Carco Investments 520 Mendocino Ave Suite 250 Santa Rosa, CA 95403 (707) 696-8588	Major Project	1.06	11 Units - SFA 2 Units - SFD	Proposed	Rose
13	MJP08-006	2957 Dutton Meadow	Homestead Lane Carco Investments 520 Mendocino Ave Suite 250 Santa Rosa, CA 95401 (707) 579-0111	Major Project Conditional Use Permit Rezoning	7.02	53 Units - SFD	Approved	Morris
14	MNP02-058	950 Stony Point Rd 1980 Sebastopol Rd	Jiffy Lube Randy Stevens 5386 Blue Ridge Trail Santa Rosa, CA 95404 (707) 542-7615	Conditional Use Permit Design Review	0.65	5,840 Sq Ft - RET	Approved	Hartman
15	MJP07-054	3192 Juniper Ave	Juniper Commercial Park Steve & Marilyn Geney 22 Benjamin Ln Petaluma, CA 94942 (707) 763-2891	Major Project Design Review	2.19	30,180 Sq Ft - LI	Approved	File
16	MJP08-009	2975 Dutton Meadow	Lantana Place Burbank Housing/Tom Lauderbach 790 Sonoma Ave Santa Rosa, CA 95404 (707) 526-1020	Major Project	3.99	96 Units - MF	Proposed	File
17	DR08-045	440 Dutton Ave	Lola's Plaza Ortega Family Properties, LLC 440 Dutton Ave Santa Rosa, CA 95407 (707) 479-5829	Design Review	2.74	12,000 Sq Ft - RET	Approved	File

NO.	FILE NO.	ADDRESS	PROJECT NAME/APPLICANT	TYPE OF ACTIVITY	ACRES	TYPE AND UNITS	STATUS	PLANNER
18	MJP07-055	2803 Dutton Meadow	Lone Star Carco Investments 520 Mendocino Ave Suite 250 Santa Rosa, CA 95404 (707) 579-0111	Major Subdivision Conditional Use Permit Rezoning	3.29	24 Units - SFD	Approved	Hayes
19	CUP06-160	2630 Stony Point Rd	Makara Courts Sam Paul Bopha 1963 Petaluma Hill Rd Santa Rosa, CA 95401 (707) 481-9594	Major Subdivision Conditional Use Permit Rezoning	0.53	6 Units - SFD 4 Units - SCND	Proposed	Hayes
20	MAJ01-007	2853 Dutton Meadow 2875 Dutton Meadow	Meadowood Ranch Brookfield Homes Bay Area Inc. 5960 Inglewood Dr #200 Pleasanton, CA 94588 (925) 743-8000	Major Subdivision	10	82 Units - SFD 82 Units - SCND	Approved	Hayes
21	MJP01-038	2727 Dutton Meadow	Meadows View Carco Investments 520 Mendocino Ave Suite 250 Santa Rosa, CA 95401 (707) 570-0111	Major Subdivision	5.8	48 Units - SFD 4 Units - SFA	Approved	Morris
22	MAJ04-016	1200 Hearn Ave	Minoia Trumark Companies 4185 Blackhawk Plaza Cir., 200 Danville, CA 94506 (925) 648-8300	Major Subdivision Rezoning Conditional Use Permit Design Review	6.4	66 Units - SFD	Approved	File
23	MJP06-028	3994 Arthur Ashe Cir	Park Lane II Mixed Use Building Menlo Oaks 1100 Larkspur Landing Cir Larkspur, CA 94939 (415) 464-8140	Major Subdivision Design Review	0.83	20 Units - SFA 5,500 Sq Ft - RET	Proposed	Rose

NO.	FILE NO.	ADDRESS	PROJECT NAME/APPLICANT	TYPE OF ACTIVITY	ACRES	TYPE AND UNITS	STATUS	PLANNER
24	MJP02-007	1550 Hearn Ave 1590 Hearn Ave	Park Village Clement & Ann Marie Carinalli 520 Mendocino Ave Suite 250 Santa Rosa, CA 95404 (707) 578-1302	Major Subdivision	7.4	16 Units - SFD 74 Units - MF	Proposed	Housh
25	CUP05-045	375 Brittain Ln	Rachel Drive Subdivision Expowth Inc/Forrest Jinks Po Box 6787 Santa Rosa, CA 95406 (707) 888-4473	Design Review Conditional Use Permit	0.85	5 Units - SFD	Approved	File
26	MJP06-034	2384 Stony Point Rd 2410 Stony Point Rd	Ridge Point Apartments AHDC Inc. 3128 Willow Ave #101 Clovis, CA 93612 (559) 292-9212	Design Review Rezoning	3.9	56 Units - MF	Approved	Morris
27	MAJ03-020	1011 Yuba Dr	Ryan Place Pine Creek Properties PO Box 11218 Santa Rosa, CA 95406 (707) 578-1125	Major Subdivision	7.6	43 Units - SFD 10 Units - MF	Proposed	Rose
28	MAJ04-039	2786 Dutton Meadow	Somerset Place Carco Investments 520 Mendocino Ave Suite 250 Santa Rosa, CA 95401 (707) 578-1302	Major Subdivision	3	32 Units - SFD	Approved	Morris
29	MJP05-036	1250 Aloise Ave	Southern Gardens DAS Homes Inc 1310 West Street Woodland, CA 95695 (530) 666-0506	Major Project Conditional Use Permit	1.99	14 Units - SFD	Approved	Hayes

NO.	FILE NO.	ADDRESS	PROJECT NAME/APPLICANT	TYPE OF ACTIVITY	ACRES	TYPE AND UNITS	STATUS	PLANNER
30	MJP01-030	533 Bellevue Ave	Southwest Estates Ryder Homes 1425 Treat Blvd. Walnut Creek, CA 94596 (925) 937-4373	Major Subdivision Rezoning Design Review	12.94	48 Units - SFD	Approved	Morris
31	MAJ09-001	3200 Dutton Ave	Stemken Park Industrial Business Park Stemken Park Unlimited/Michael Whipple PO Box 151626 San Rafael, CA 94915 (415)459-6966	Condo Conversion	5.95	62 Units - CNV	Approved	Rose
32	MJP05-010	2733 Stony Point Rd	Stony Village Carco Investments 520 Mendocino Ave Santa Rosa, CA 95401 (707) 579-0111	Major Subdivision Conditional Use Permit Rezoning	4.95	44 Units - SFA	Proposed	Rose
33	MJP05-020	1755 Sebastopol Rd	The Villas Sebastopol Rd Inv LLC 1421 Guerneville Rd Suite 212 Santa Rosa, CA 95403 (707) 568-3500	Major Project	14.19	198 Units - SFA 22,000 Sq Ft - RET	Approved	Morris
34	MAJ06-039	801 Dutton Ave	Walkham Place Townhomes Leonard Gordon & Chandra Geiger PO Box 2088 Mill Valley, CA 94943 (415) 923-0992	Condo Conversion	2.04	27 Units - CNV	Approved	Morris
35	MJP04-031	4055 Sebastopol Rd 4025 Sebastopol Rd 4041, 4099 Sebastopol Rd	West Entry Alan Strachan 3929 New Zealand Ave Santa Rosa, CA 95407 (707) 591-0880	Major Subdivision Rezoning	9.5	139 Units - SFA 23,278 Sq Ft - RET	Approved	File

NO.	FILE NO.	ADDRESS	PROJECT NAME/APPLICANT	TYPE OF ACTIVITY	ACRES	TYPE AND UNITS	STATUS	PLANNER
36	DR05-048	1810 Sebastopol Rd	Wonder Bread Building Boriolo Construction 1840 Burbank Ave Santa Rosa, CA 95407 (707) 577-8802	Design Review	0.85	5,600 Sq Ft - LI	Approved	Hartman
37	MNP06-019	1078 South Wright Rd	Zabaneh Mixed Use Fred Zabaneh 5745 Davis Circle Rohnert Park, CA 94928 (707) 579-1952	Conditional Use Permit Design Review	0.9	18 Units - MF 4,413 Sq Ft - RET	Proposed	Jones